

6700 MM WIDE MUNICIPALITY ROAD

33600

6700 MM WIDE MUNICIPALITY ROAD

40500

TO NEWTAJI ROAD

9750 MM WIDE PWD ROAD

TO NEW ALIPURDUAR STATION

VACANT LAND

Adminstrator
Alipurduar Municipality

PROPOSED BUILDING (A)

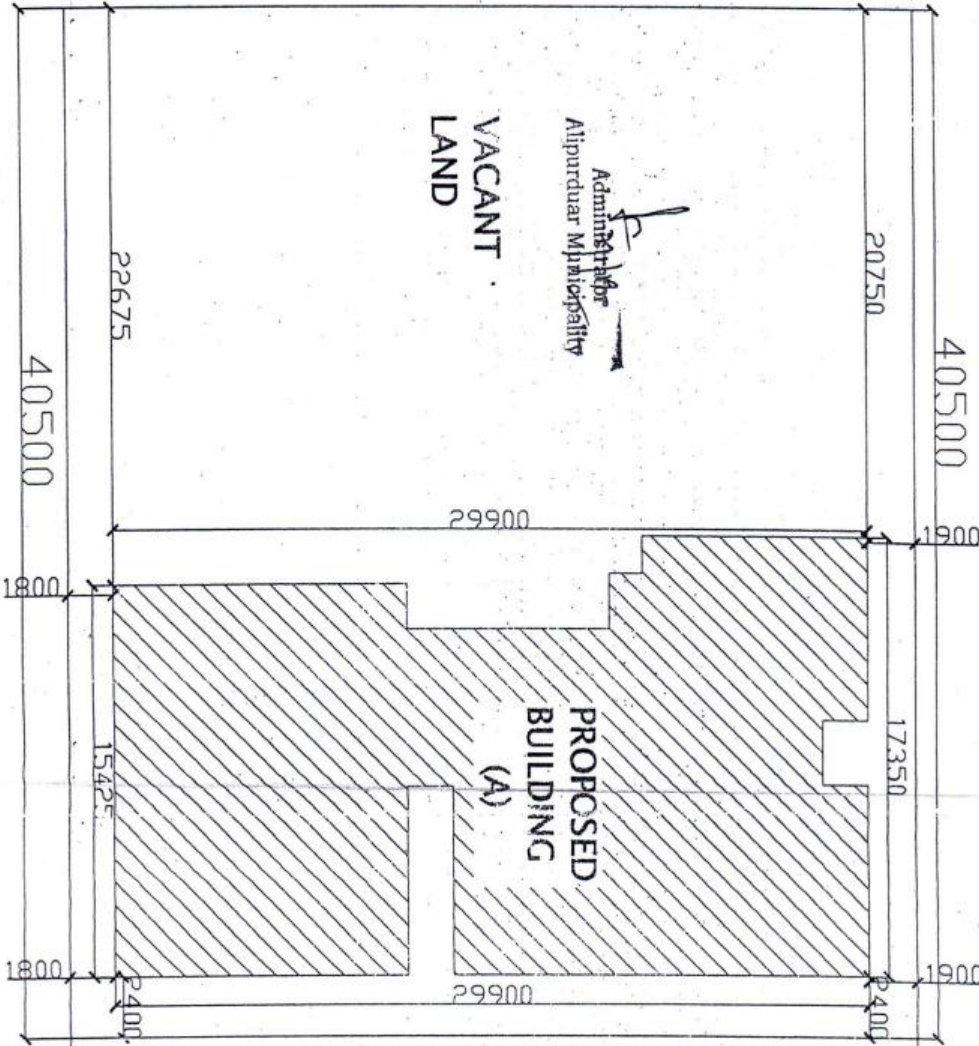

LAND OF BIKASH ROY & SUKUMAR BARMAR

SITE PLAN
SCALE - 1:200

Checked and found Correct
21/11/16
Alipurduar Municipality

PROJECT :-	
SITE PLAN SHOWING (PARKING + FOUR STOREYED RESIDENTIAL BUILDING TO BE CONPRSTRUCTED BY M/S HIMALAYAN BUILDERS & DEVELOPERS PARTNERSHIP FARM OF NEWTOWN, ALIPURDUAR.	
LOCATION :- NEWTOWN, ALIPURDUAR WARD NO : IV, DIST - ALIPURDUAR	
SHEDULE OF LAND:- PLOT NO - 1042 KHATTAN NO : 8797 J.L. NO. : 51 HOLDING NO - 1379	
LAND AREA:-	MOUZA : DAMANPUR P.S. : ALIPURDUAR DIST : ALIPURDUAR WARD NO. : IV, OF ALIPURDUAR MUCPL
AREA OF LAND : 0.34 ACRE = 1375.92 SQM (AS / KHATTAN) AREA OF LAND : = 1360.80 SQM (AS / SITE)	
AREA STATEMENT	PROPOSED
GROUND COVERAGE OF 1 BUILDING (A)	33%
TOTAL GROUND COVERAGE WITH TWO BUILDINGS	67%
LEFT OPEN SPACE AREA USE OF THE BUILDING	911.508 SQM (P+4) - STD. RESI. BUILDING.
TENEMENT	44 NOS.
SIGN OF OWNER	SIGN OF ENGINEER
<i>Signed by NY</i>	<i>Signed by NY</i>